

### Bearing No. 51108

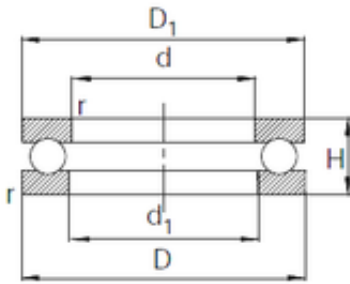

Bore Diameter	40 mm
Outer Diameter	60 mm
d	40 mm
d1	42 mm
D	60 mm
D1	60 mm
H	13 mm
r min.	0.6 mm
Weight	0.120 Kg
Basic dynamic load rating (C)	27,1 kN
Basic static load rating (C0)	63 kN
(Grease) Lubrication Speed	3600 r/min